

Micro super-rapid fittings for plastic tubes

Series 6000 Micro

Tube external \varnothing 3 , 4, 6,8 and 10 mm
Connections M3, M5, M7, G1/8 and G1/4

4



Micro Super-Rapid fittings are constructed in 14 different models. Connection and disconnection of the tube, can be repeated several times and can be performed using one hand and without the use of tools. The sealing ring (O-Ring) can be easily replaced if it is damaged or should the rubber compound from which it is made wear with time.

This advantage derives from the simple execution of the internal collet, which can be extracted allowing the replacement of the O-Ring.

GENERAL DATA

| | |
|------------------------|--|
| Material | body and collet: brass OT nickel-plated O-Ring NBR, seal PTFE, NBR, PA |
| Threads | M3 - M5 - M7 - G1/8 - G1/4 |
| Pressure | min. -0,8 - max. 16 bar (see tubing) |
| Tube to connect | rilsan, PA 6 - 11 - 12 , polyethylene, polyurethane |
| Diameters | \varnothing 3 - 4 - 6 - 8 - 10 mm |
| Fluid | compressed air (for other types of fluid, contact our engineers) |
| Temperature | -10°C + 60°C (see data for tubing used) |

Fitting with conduction tube

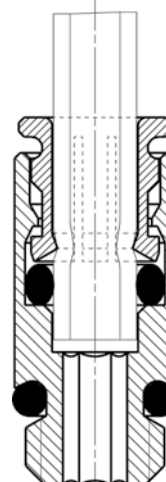

Fittings Mod. 6512

● = with O-Ring assembled
 * = with Mod. 2661 assembled.

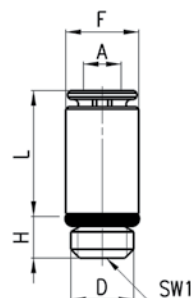

DIMENSIONS

| Mod. | A | D | F | H | L | SW1 | |
|----------------------|----|------|------|-----|------|-----|---|
| 6512 3-M3 | 3 | M3 | 5,8 | 2,5 | 10,2 | 1,5 | * |
| 6512 3-M5 | 3 | M5 | 5,8 | 3,5 | 10 | 2 | ● |
| 6512 4-M7-M | 4 | M7 | 9,4 | 5 | 17,5 | 2,5 | ● |
| 6512 4-1/8-M | 4 | G1/8 | 11,2 | 5 | 13 | 2,5 | ● |
| 6512 6-M7-M | 6 | M7 | 10,4 | 5 | 17 | 4 | ● |
| 6512 6-1/8-M | 6 | G1/8 | 11,2 | 5 | 14 | 4 | ● |
| 6512 8-1/8-M | 8 | G1/8 | 12,4 | 5 | 18,5 | 5 | ● |
| 6512 10-1/4-M | 10 | G1/4 | 14,8 | 6 | 27 | 7 | ● |

Fittings Mod. 6522

Swivel elbow

● = with O-Ring assembled
 * = with Mod. 2661 assembled.

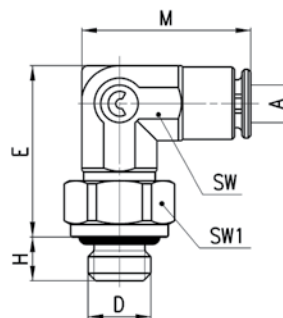

DIMENSIONS

| Mod. | A | D | E | H | M | SW | SW1 | |
|------------------|---|----|------|-----|------|----|-----|---|
| 6522 3-M3 | 3 | M3 | 13,7 | 2,5 | 13,7 | 6 | 6 | * |
| 6522 3-M5 | 3 | M5 | 13,7 | 3,5 | 13,7 | 6 | 8 | ● |

Fittings Mod. 6621

Adjustable with Mod. 2661 assembled.

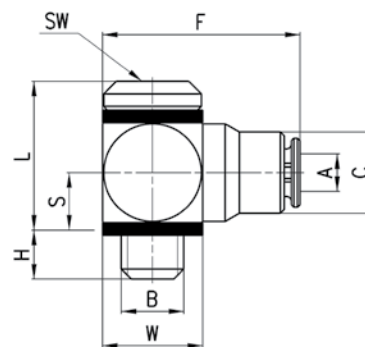

DIMENSIONS

| Mod. | A | B | C | F | H | L | S | W | SW |
|------------------|---|----|-----|------|-----|------|-----|---|-----|
| 6621 3-M3 | 3 | M3 | 5,8 | 14,2 | 2,5 | 9,3 | 3,5 | 6 | 1,5 |
| 6621 3-M5 | 3 | M5 | 6,5 | 16 | 3,2 | 11,9 | 4,8 | 8 | 2 |

Fittings Mod. 6432

Swivel branch tee

● = with O-Ring assembled

* = with Mod. 2661 assembled.

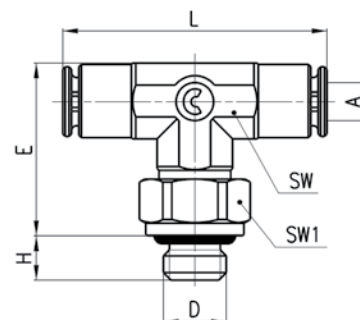

DIMENSIONS

| Mod. | A | D | E | H | L | SW | SW1 | |
|------------------|---|----|------|-----|------|----|-----|---|
| 6432 3-M3 | 3 | M3 | 13,7 | 2,5 | 21,4 | 6 | 6 | * |
| 6432 3-M5 | 3 | M5 | 13,7 | 3,5 | 21,4 | 6 | 8 | ● |

Fittings Mod. 6442

Swivel run tee

● = with O-Ring assembled

* = with Mod. 2661 assembled.

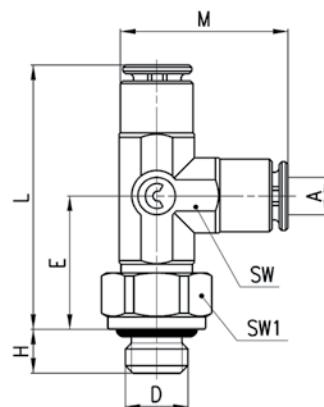

DIMENSIONS

| Mod. | A | D | E | H | L | M | SW | SW1 | |
|------------------|---|----|------|-----|------|------|----|-----|---|
| 6442 3-M3 | 3 | M3 | 10,7 | 2,5 | 21,4 | 13,7 | 6 | 6 | * |
| 6442 3-M5 | 3 | M5 | 12,2 | 3,5 | 21,4 | 13,7 | 6 | 8 | ● |

Fittings Mod. 6452

Swivel Y connector

● = with O-Ring assembled

* = with Mod. 2661 assembled.

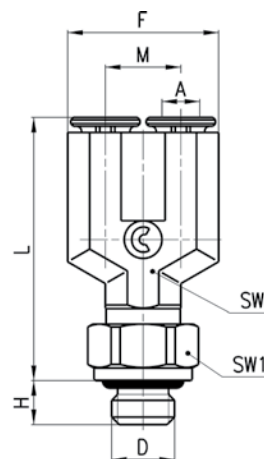

DIMENSIONS

| Mod. | A | D | F | H | L | M | SW | SW1 | |
|------------------|---|----|----|-----|------|---|----|-----|---|
| 6452 3-M3 | 3 | M3 | 12 | 2,5 | 20,9 | 6 | 6 | 6 | * |
| 6452 3-M5 | 3 | M5 | 12 | 3,5 | 20,9 | 6 | 6 | 8 | ● |

Fitting Mod. 6580 3

Rings UNI 7435 and DIN 471

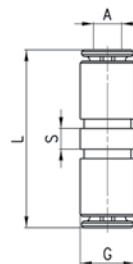

DIMENSIONS

| Mod. | A | G | L | S |
|---------------|---|-----|------|-----|
| 6580 3 | 3 | 5,8 | 19,9 | 2,2 |

Fitting Mod. 6550 3

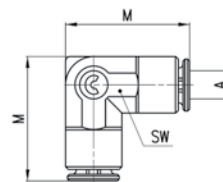

DIMENSIONS

| Mod. | A | M | SW |
|---------------|---|------|----|
| 6550 3 | 3 | 13,7 | 6 |

Fitting Mod. 6540 3

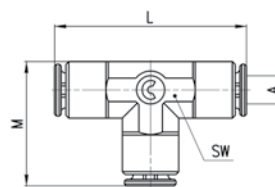

DIMENSIONS

| Mod. | A | L | M | SW |
|---------------|---|------|------|----|
| 6540 3 | 3 | 21,4 | 13,7 | 6 |

Fitting Mod. 6590 3

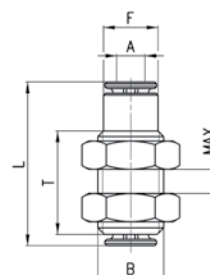

DIMENSIONS

| Mod. | A | B | F | L | MAX | T |
|---------------|---|---------|-----|------|-----|------|
| 6590 3 | 3 | M7X0,75 | 5,8 | 18,4 | 5 | 11,4 |

Fitting Mod. 6560

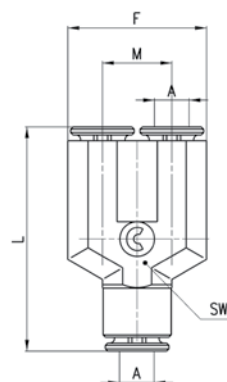

DIMENSIONS

| Mod. | A | F | L | M | SW |
|---------------|---|----|------|---|----|
| 6560 3 | 3 | 12 | 20,4 | 6 | 6 |

Cartridge Mod. 6700 3

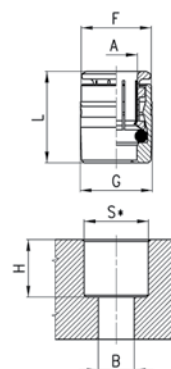

DIMENSIONS

| Mod. | A | F | G | H | L | S | B |
|---------------|---|-----|-----|-----|-----|---|---|
| 6700 3 | 3 | 5,9 | 6,2 | 6,3 | 9,2 | 6 | 2 |

Fitting Mod. 6800 3-4

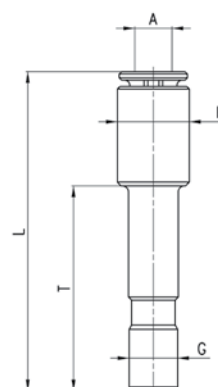

DIMENSIONS

| Mod. | A | F | G | L | T |
|-----------------|---|-----|---|----|------|
| 6800 3-4 | 3 | 5,8 | 4 | 26 | 16,5 |

Plug Mod. 6900 3



Plastic

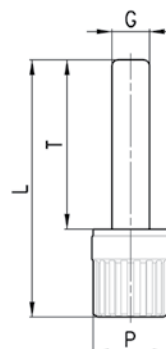

DIMENSIONS

| Mod. | G | L | P | T |
|---------------|---|------|---|------|
| 6900 3 | 3 | 20,5 | 6 | 13,5 |