

Lockable isolation 3/2-way valve Series C

3

Port G1
Compact



This valve is designed so that the downstream air pressure can be vented and the valve locked in the non passing condition to allow the work to be carried out with greater safety on pneumatically actuated equipment.

The positioning of this valve is often before the FRL unit.

The lockable isolation valve is available with port G1 and cannot be panel mounted.

GENERAL DATA

Construction	poppet valve, compact
Materials	aluminium, brass, technopolymer, NBR
Port	G1
Weight	kg 1,600
Mounting	in-line or wall mounting
Operating temperature	0°C + 50°C
Finishing	enamelled
Operating pressure	0 + 16 bar
Nominal flow	see graph
Nominal flow in the exhausted direction	G1 4105 NI/min
Nominal flow determined with	6 bar at $\Delta P = 1$ bar

CODING EXAMPLE

C	4	01	-	V	00
----------	----------	-----------	----------	----------	-----------

C	SERIES
4	SIZE: 4 = G1
01	PORT : 01 = G1
V	V = 3/2-WAY VALVE
00	DESIGN TYPE: 00 = padlock valve (manual command)

3

FLOW DIAGRAM C401-V00

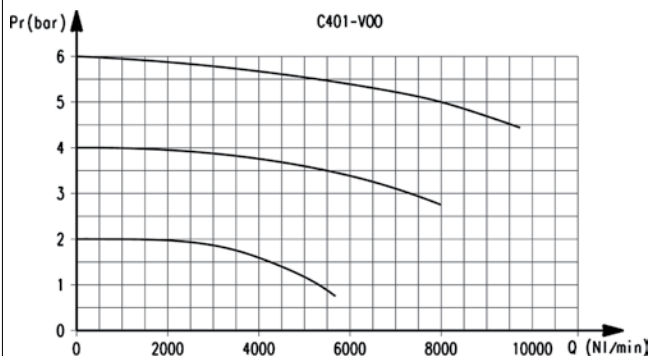

Pr = Regulated pressure
Qn = Flow

Lockable isolation valve Series C

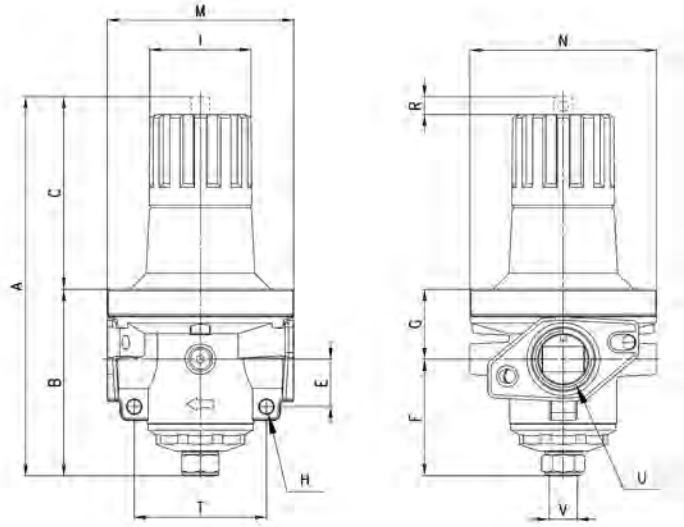
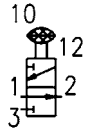

DIMENSIONS

Mod.	A	B	C	E	F	G	H	I	M	N	R	T	U	V
C401-V00	223,5	110	113,5	28	70	40	8	60	110	110	10,5	78	G1	G3/8