

# Pipe fittings Sprint® Series S2000

Connections G1/8, G1/4, G3/8, G1/2  
R1/8, R1/4, R3/8, R1/2

4



The Sprint® fittings are available in 15 different models, and all have conical threads. The characteristic of this series is that the conical thread has an incorporated torque system which avoids the use of liquid glues or P.T.F.E. band, avoiding the operator to loose time in the mounting phases.

The system moreover guarantees extreme cleanliness in the mounting phase and the possibility to connect and disconnect repeatedly the fitting, without compromising the seal on the thread.

## GENERAL DATA

<b>Material</b>	OT58 nickel plated and P.T.F.E.
<b>Threads</b>	GAS conical ISO 7 ( BSPT ) GAS cylindrical ISO 228 ( BSP )
<b>Pressure</b>	40 Bar
<b>Fluid</b>	compressed air and other low pressure fluids
<b>Temperature</b>	-40°C ÷ 120°C

## Pipe fittings Sprint®

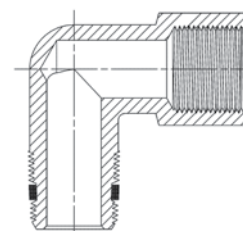

## Fittings Mod. S2500

Sprint®

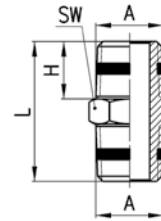

## DIMENSIONS

Mod.	A	H	L	SW
<b>S2500 1/8</b>	R1/8	7,5	19,5	12
<b>S2500 1/4</b>	R1/4	11	27	14
<b>S2500 3/8</b>	R3/8	11,5	28	17
<b>S2500 1/2</b>	R1/2	14	33,5	22

## Fittings Mod. S2530

Sprint®

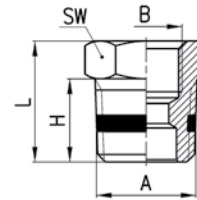

## DIMENSIONS

Mod.	A	B	H	L	SW
<b>S2530 1/4-1/8</b>	R1/4	G1/8	11	16	14
<b>S2530 3/8-1/8</b>	R3/8	G1/8	11,5	16,5	17
<b>S2530 1/2-1/8</b>	R1/2	G1/8	14	19,5	22
<b>S2530 3/8-1/4</b>	R3/8	G1/4	11,5	16,5	17
<b>S2530 1/2-1/4</b>	R1/2	G1/4	14	19,5	22
<b>S2530 1/2-3/8</b>	R1/2	G3/8	14	19,5	22

## Fittings Mod. S2520

Sprint®

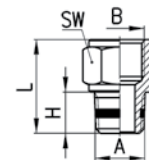

## DIMENSIONS

Mod.	A	B	H	L	SW
<b>S2520 1/8-1/8</b>	R1/8	G1/8	7,5	17,5	13
<b>S2520 1/8-1/4</b>	R1/8	G1/4	7,5	19	17
<b>S2520 1/8-3/8</b>	R1/8	G3/8	7,5	20	20
<b>S2520 1/4-1/4</b>	R1/4	G1/4	11	22,5	17
<b>S2520 1/4-3/8</b>	R1/4	G3/8	11	23,5	20
<b>S2520 1/4-1/2</b>	R1/4	G1/2	11	27,5	24
<b>S2520 3/8-3/8</b>	R3/8	G3/8	11,5	24	20
<b>S2520 3/8-1/2</b>	R3/8	G1/2	11,5	28	24
<b>S2520 1/2-1/2</b>	R1/2	G1/2	14	30,5	24

Fittings Mod. S2510

Sprint®

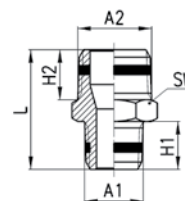

DIMENSIONS						
Mod.	A1	A2	H1	H2	L	SW
<b>S2510 1/8-1/4</b>	R1/8	R1/4	7,5	11	23,5	14
<b>S2510 1/8-3/8</b>	R1/8	R3/8	7,5	11,5	24	17
<b>S2510 1/4-3/8</b>	R1/4	R3/8	11	11,5	27,5	17
<b>S2510 1/4-1/2</b>	R1/4	R1/2	11	14	30,5	22
<b>S2510 3/8-1/2</b>	R3/8	R1/2	11,5	14	31	22

Fittings Mod. 2541

Sprint®



Mod. Sprint swivel.

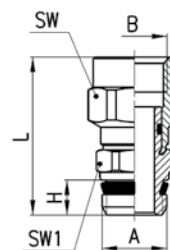

DIMENSIONS						
Mod.	A	B	H	L	SW	SW1
<b>2541 1/8-1/8</b>	G1/8	G1/8	5,5	28	13	14
<b>2541 1/4-1/4</b>	G1/4	G1/4	7	31,5	17	14
<b>2541 3/8-3/8</b>	G3/8	G3/8	8	34	20	19

Fittings Mod. S2010

Sprint®

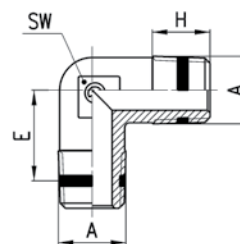

DIMENSIONS				
Mod.	A	E	H	SW
<b>S2010 1/8</b>	R1/8	11,5	7,5	9
<b>S2010 1/4</b>	R1/4	13,5	11	12
<b>S2010 3/8</b>	R3/8	15,5	11,5	14
<b>S2010 1/2</b>	R1/2	16	14	16

Fittings Mod. S2020

Sprint®

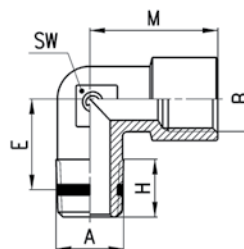

DIMENSIONS						
Mod.	A	B	E	H	M	SW
<b>S2020 1/8-1/8</b>	R1/8	G1/8	11,5	8,5	19	12
<b>S2020 1/4-1/4</b>	R1/4	G1/4	15	11	23	14
<b>S2020 3/8-3/8</b>	R3/8	G3/8	15	11,5	25	16
<b>S2020 1/2-1/2</b>	R1/2	G1/2	17,5	14	31,5	20

Fittings Mod. S2040

Sprint®

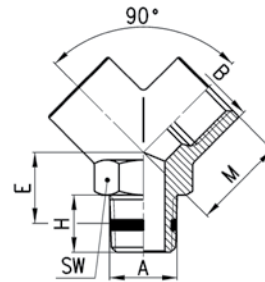

DIMENSIONS

Mod.	A	B	E	H	M	SW
<b>S2040 1/8-1/8</b>	R1/8	G1/8	13	8,9	17,5	14
<b>S2040 1/4-1/4</b>	R1/4	G1/4	13	11	18,5	17
<b>S2040 3/8-3/8</b>	R3/8	G3/8	18	13	22,5	22
<b>S2040 1/2-1/2</b>	R1/2	G1/2	22,5	15,3	27,5	26

Fittings Mod. S2050

Sprint®

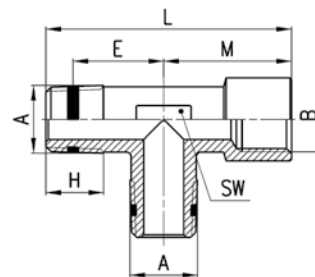

DIMENSIONS

Mod.	A	B	E	H	L	M	SW
<b>S2050 1/8-1/8</b>	R1/8	G1/8	11,5	8,5	37	19	12
<b>S2050 1/4-1/4</b>	R1/4	G1/4	15	11	46	23	14
<b>S2050 3/8-3/8</b>	R3/8	G3/8	15	11,5	48,5	25	16
<b>S2050 1/2-1/2</b>	R1/2	G1/2	17,5	14	60,5	31,5	20

Fittings Mod. S2060

Sprint®

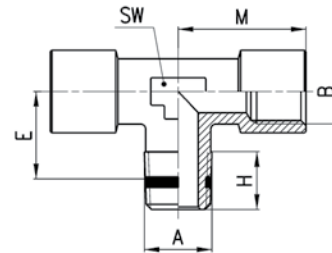

DIMENSIONS

Mod.	A	B	E	H	M	SW
<b>S2060 1/8-1/8</b>	R1/8	G1/8	11,5	8,5	19	12
<b>S2060 1/4-1/4</b>	R1/4	G1/4	15	11	23	14
<b>S2060 3/8-3/8</b>	R3/8	G3/8	15	11,5	25	16
<b>S2060 1/2-1/2</b>	R1/2	G1/2	17,5	14	31,5	20

Fittings Mod. S2070

Sprint®

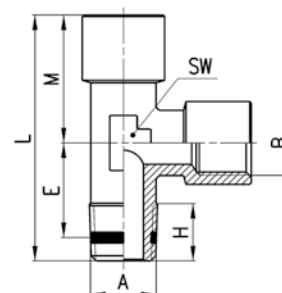

DIMENSIONS

Mod.	A	B	E	H	L	M	SW
<b>S2070 1/8-1/8</b>	R1/8	G1/8	11,5	8,5	37	19	12
<b>S2070 1/4-1/4</b>	R1/4	G1/4	15	11	46	23	14
<b>S2070 3/8-3/8</b>	R3/8	G3/8	15	11,5	48,5	25	16
<b>S2070 1/2-1/2</b>	R1/2	G1/2	17,5	14	60,5	31,5	20

Fittings Mod. S2080

Sprint®

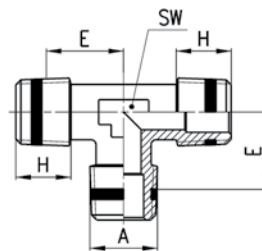

DIMENSIONS				
Mod.	A	E	H	SW
S2080 1/8	R1/8	11,5	7,5	9
S2080 1/4	R1/4	13,5	11	12
S2080 3/8	R3/8	15,5	11,5	14
S2080 1/2	R1/2	16	14	16

Fittings Mod. S2090

Sprint®

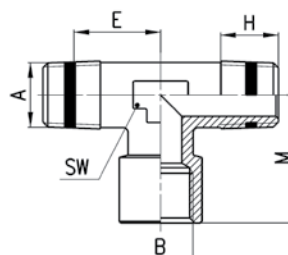

DIMENSIONS						
Mod.	A	B	E	H	M	SW
S2090 1/8-1/8	R1/8	G1/8	11,5	8,5	19	12
S2090 1/4-1/4	R1/4	G1/4	15	11	23	14
S2090 3/8-3/8	R3/8	G3/8	15	11,5	25	16
S2090 1/2-1/2	R1/2	G1/2	17,5	14	31,5	20

Fittings Mod. S2610

Sprint®

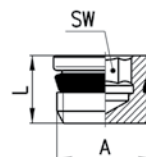

DIMENSIONS			
Mod.	A	L	SW
S2610 1/8	G1/8	7,5	4
S2610 1/4	G1/4	9	6
S2610 3/8	G3/8	10	8
S2610 1/2	G1/2	11	10

Fittings Mod. S2615

Sprint®

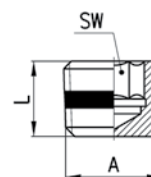

DIMENSIONS			
Mod.	A	L	SW
S2615 1/8	R1/8	8	5
S2615 1/4	R1/4	10	7
S2615 3/8	R3/8	10	8